

(Parts Pages Follow)

## ATTENTION

If you need an Owner's/Operator's Manual and/or safety signs (decals), then please contact Danuser. Provide your Model Number and Serial Number, and we will be happy to mail it to you.

Danuser Machine Company, Inc.

500 E. 3<sup>rd</sup> St.

P.O. Box 368

Fulton, MO 65251

Tel: (573) 642-2246

Fax: (573) 642-2240

E-mail: [sales@danuser.com](mailto:sales@danuser.com)

**DANUSER HYDRAULIC BORING HEAD  
MODEL 8800-1& 8800-2  
PARTS ASSEMBLY**

- 2— HEX WASHER MACHINE SCREW — 6162
- 1— UPPER CLAMP — 6161
- 1— LOWER CLAMP — 6160
- 2— HEX FLANGE NUT — 6090
- 1— SERIAL NUMBER

 = Safety Sign Location

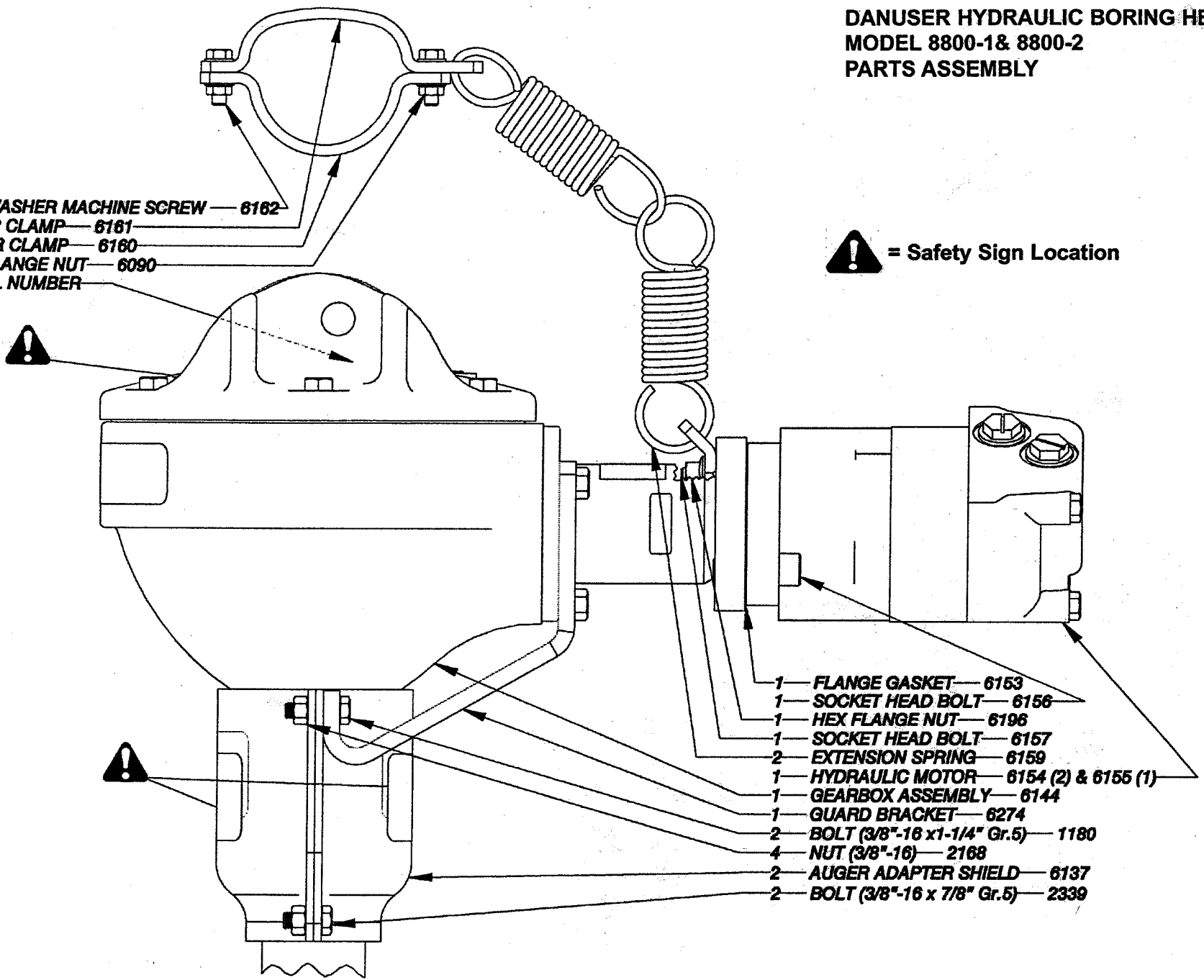

- 1— FLANGE GASKET — 6153
- 1— SOCKET HEAD BOLT — 6156
- 1— HEX FLANGE NUT — 6196
- 1— SOCKET HEAD BOLT — 6157
- 2— EXTENSION SPRING — 6159
- 1— HYDRAULIC MOTOR — 6154 (2) & 6155 (1)
- 1— GEARBOX ASSEMBLY — 6144
- 1— GUARD BRACKET — 6274
- 2— BOLT (3/8"-16 x 1-1/4" Gr.5) — 1180
- 4— NUT (3/8"-16) — 2168
- 2— AUGER ADAPTER SHIELD — 6137
- 2— BOLT (3/8"-16 x 7/8" Gr.5) — 2339

**DANUSER HYDRAULIC BORING HEAD  
MODEL 8800-1 & 8800-2  
GEARBOX ASSEMBLY**

**PACK 6007, 6009, & 6013 CONES WITH SHELL  
ALVANIA EP GREASE 2 OR EQUIV.**

**APPLY LOCKTITE 515 OR PERMA-LOK HH190 TO  
MOUNTING SURFACE OF 6111 & 6148 JUST BEFORE  
ASSEMBLY. SURFACE MUST BE FREE OF ANY  
PARTICLES THAT WOULD NOT ALLOW SURFACES  
TO CLAMP COMPLETELY TOGETHER.**

**TIGHTEN BOLTS 6058 & 6059 TO 50 LB.-FT.**

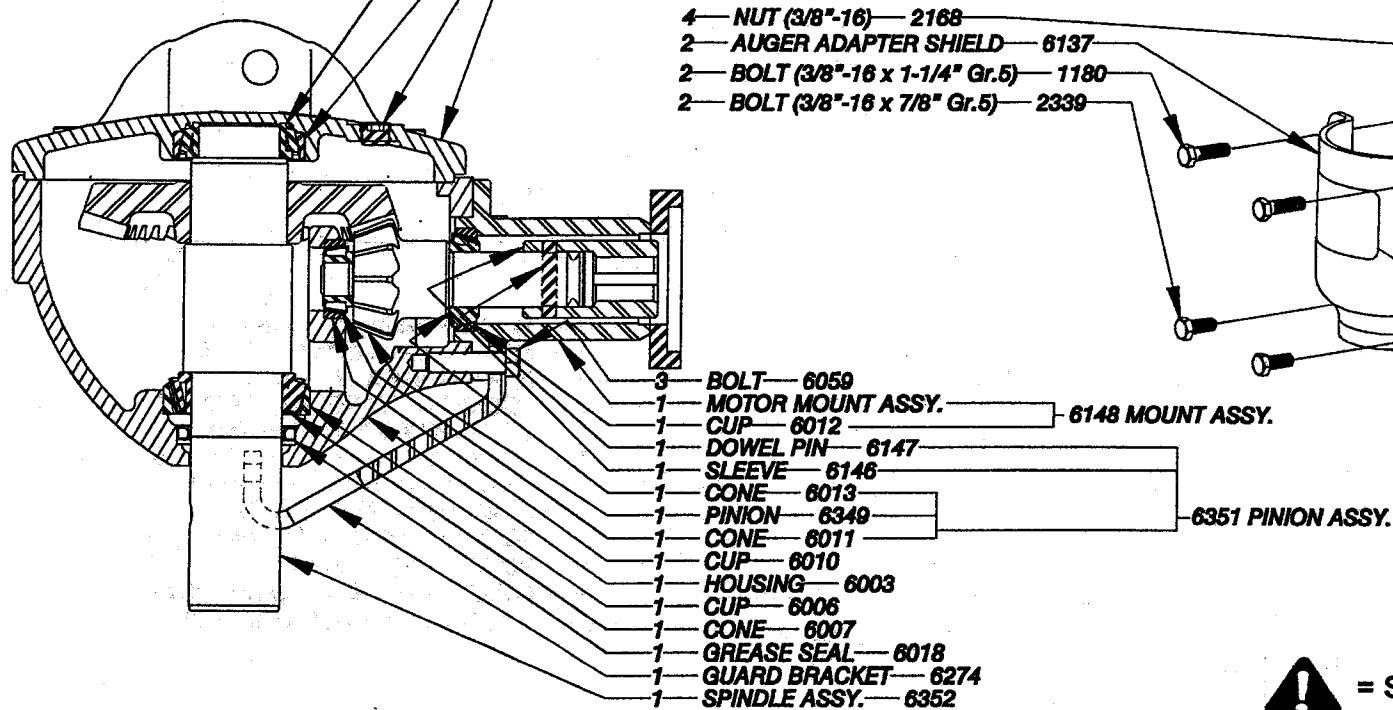
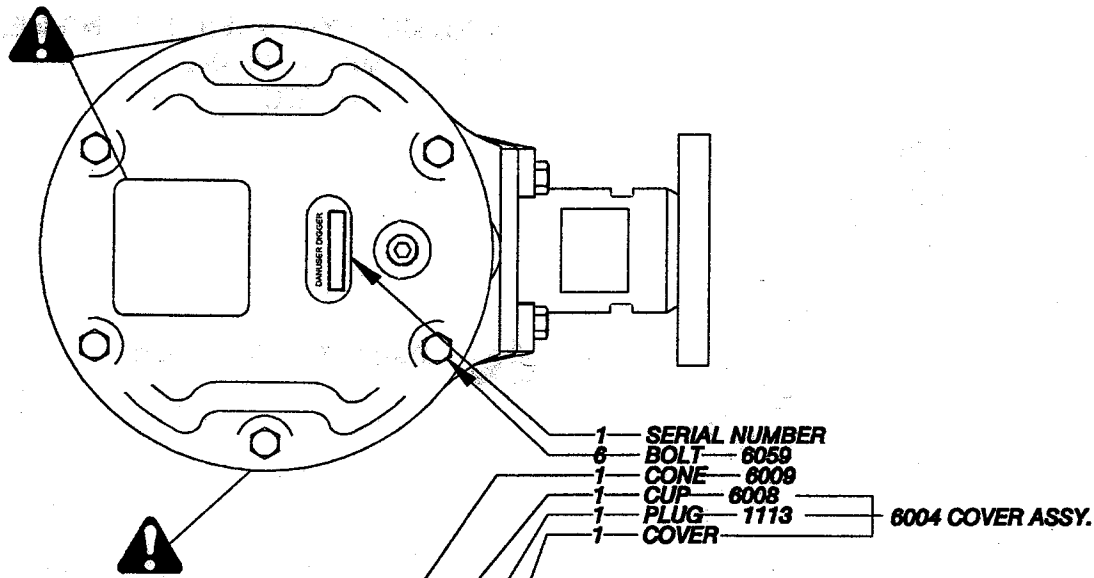

**! = Safety Sign Location**

# Auger Assemblies



When using an extension, Ref. No. 8 (PN 6014) and Ref. No. 9 (PN 1056) should be relocated from the auger adapter to the extension adapter, and Ref. No. 11 (PN 6239) should be used to attach the auger to the extension to avoid possible entanglement.

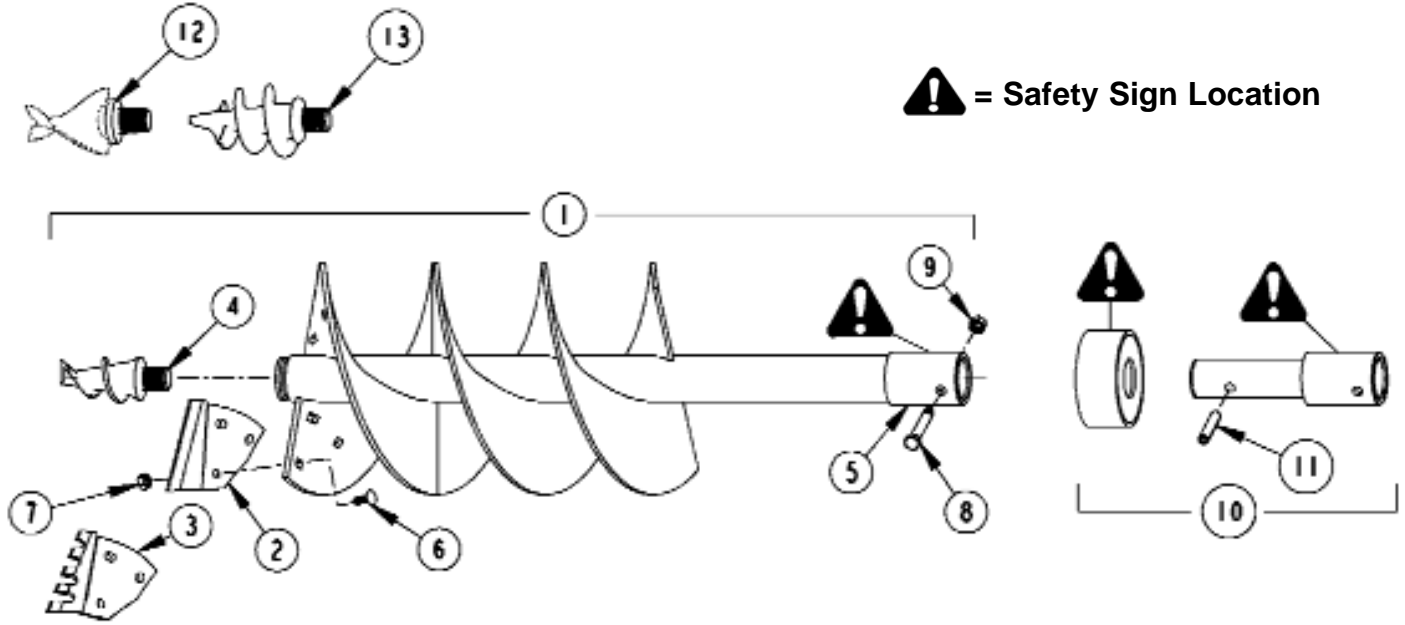

**NOTE**

Augers have replaceable points and edges. Serrated cutting edges (Ref. No. 3) and optional points (Ref. No. 12 and Ref. No. 13) are available to aid penetration in tough digging conditions. Flights are replaceable except on 4" and 6", where the flight is a continuous spiral. Cutting edges on 4" and 6" augers are welded on the auger.

## AUGER ASSEMBLIES FOR 2" ROUND SPINDLES

Ref. No.	Part Number by Auger Diameter								Description	No. Req'd
	4"	6"	9"	12"	14"	16"	18"	24"		
1	See next page for available augers.								Auger	1
2	7782	7783							Plain Cutting Edges (Weld On)	1 Set
			7784	7790	7792	7794	7796	7798	Plain Cutting Edges (with Bolts & Nuts)	1 Set
3			7785	7791	7793	7795	7797	7799	Serrated Cutting Edges (with Bolts & Nuts)	1 Set
4	899	831	831	831	831	831	831	831	Standard Auger Point	1
5	6019	6019	6019	6019	6019	6019	6019	6019	Auger Adapter Replacement (for Field Welding)	1
6			784	784	784	784	784	784	Cutting Edge Bolt (3/8"-16 x 1" Carriage)	As Req'd
7			785	785	785	785	785	785	Cutting Edge Nut (3/8"-16 Hex)	As Req'd
8	6014	6014	6014	6014	6014	6014	6014	6014	Retaining Bolt (1/2"-13 x 3-1/4" Gr. 8, 1/2" of thread) <b>SPECIAL BOLT:</b> Use Genuine Danuser Replacement Only	1
9	1056	1056	1056	1056	1056	1056	1056	1056	Retaining Nut (1/2"-13 Hex)	1
10	6080G	6080G	6080G	6080G	6080G	6080G	6080G	6080G	Auger Extension with Guard (7")	1
	6204G	6204G	6204G	6204G	6204G	6204G	6204G	6204G	Auger Extension with Guard (14")	1
11	6239	6239	6239	6239	6239	6239	6239	6239	Coiled Pin (1/2" x 2-3/4") <b>SPECIAL PIN:</b> Use Genuine Danuser Replacement Only	1
12		1937	1937	1937	1937	1937	1937	1937	Special Duty Auger Point	1
13		6210	6210	6210	6210	6210	6210	6210	Aggressive Duty Auger Point	1

# 2" Round Augers

 = Safety Sign Location

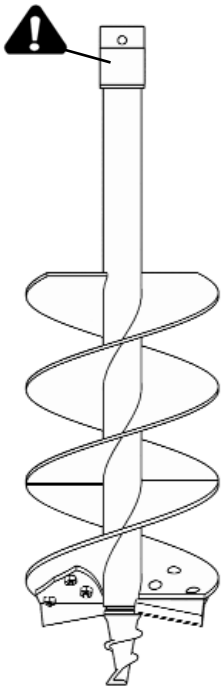

## 2" ROUND SPINDLE AUGERS

Part Number by Auger Diameter								Description
4"	6"	9"	12"	14"	16"	18"	24"	
6101	6029	6030	6032	6034	6036	6038	6040	40" Long with Plain Edges & Standard Point
		6031	6033	6035	6037	6039	6041	40" Long with Serrated Edges & Standard Point

## 2" ROUND SPINDLE STEPPED AUGERS

Part Number by Auger Diameter			Description
18" x 10"	24" x 12"	30" x 16"	
6240			33" Long with Plain Edges & Standard Point Auger Uses Both Dimensions of Cutting Edges
6248			33" Long with Serrated Edges & Standard Point Auger Uses Both Dimensions of Cutting Edges
	6241	6242	40" Long with Plain Edges & Standard Point Auger Uses Both Dimensions of Cutting Edges
	6249	6250	40" Long with Serrated Edges & Standard Point Auger Uses Both Dimensions of Cutting Edges

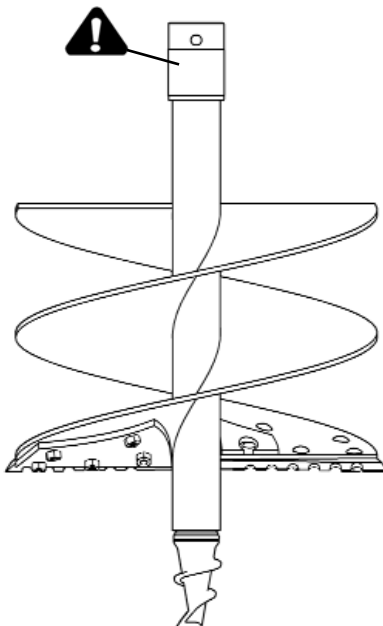
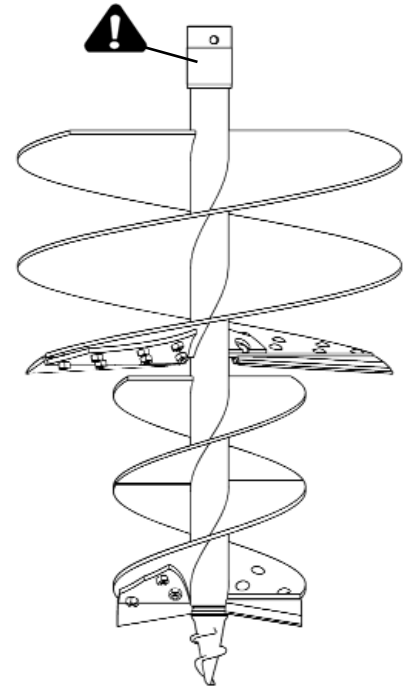

## 2" ROUND SPINDLE ORCHARD AUGERS

Part Number by Auger Diameter		Description
18"	24"	
6256	6255	29" Long with Serrated Edges & Standard Point

# Hole Digger Head Auger Assemblies

 = Safety Sign Location

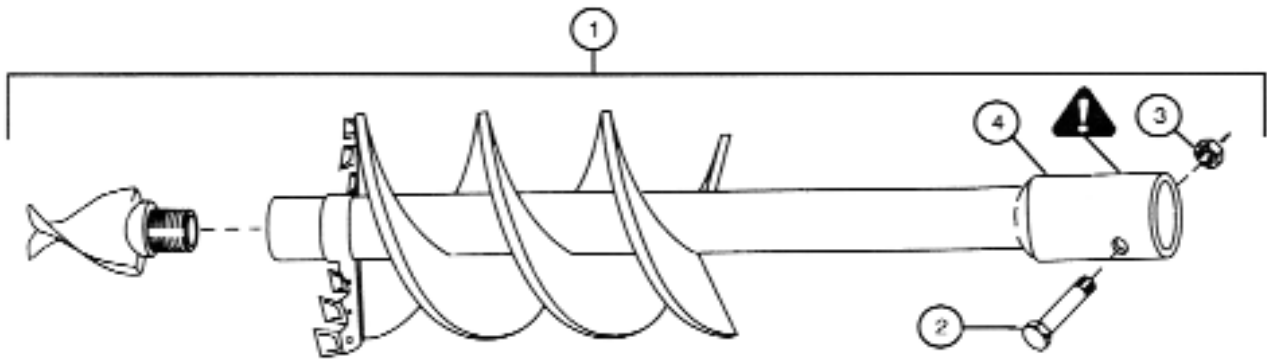

**NOTE** Hole Digger Head Augers have replaceable points and teeth. Flights are replaceable, except on 6".

**NOTE** Auger Point PN 9353 is the only auger point that can be used with Hole Digger Heads.

## AUGER ASSEMBLIES WITH HOLE DIGGER HEADS FOR 2" ROUND SPINDLES

Ref. No.	Part Number by Auger Diameter					Description	No. Req'd
	6"	9"	12"	14"	16"		
1	6121	6122	6123	6124	6125	40" Hole Depth Auger with Double Flight Construction	1
2	6014	6014	6014	6014	6014	Retaining Bolt (1/2"-13 x 3-1/4" Gr. 8, 1/2" of thread) <b>SPECIAL BOLT:</b> Use Genuine Danuser Replacement Only	1
3	1056	1056	1056	1056	1056	Retaining Nut (1/2"-13)	1
4	6019	6019	6019	6019	6019	Auger Adapter Replacement (for Field Welding)	1

Hole Digger Head Kits can be welded onto standard augers.



### HOLE DIGGER HEAD REPLACEMENT PARTS

Ref. No.	Description	Part. No.
1	Hole Digger Head Point	9353
2	Hole Digger Head Tooth	9234
	Hard-Surface Tooth (option)	9964
3	Roll Pin (5/16" x 1-1/4")	7483

### HOLE DIGGER HEAD KIT\* (Field Weld to Auger)

Auger Diameter	No. Teeth per Head	Part. No.
6"	2	9386
9"	4	9306
12"	4	9308
14"	6	9309
16"	6	9310

\* Includes head with teeth and roll pins, point and point adapter with tube, for welding to auger center column.

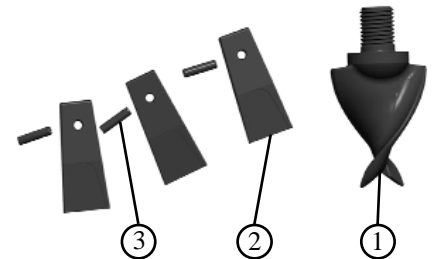

# Accessories

Standard



1

Special Duty



2

Aggressive Duty



3

## AUGER POINTS

Ref. No.	Description	Part No.
1	Standard for augers 6" through 24" diameter . . . . .831 <b>only</b> point for 4" augers . . . . .899	
2	Special Duty . . . . .1937	
3	Aggressive Duty . . . . .6210	

See Hole Digger Head Point on separate page.

Plain

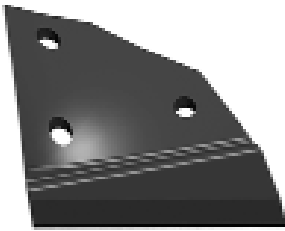

1

Serrated

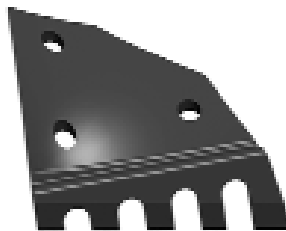

2

## CUTTING EDGES

Ref. No.	Description	Part No.
1	Plain . . . . .See charts	
2	Serrated . . . . .See charts	

See Hole Digger Head Teeth on separate page.

## AUGER EXTENSIONS

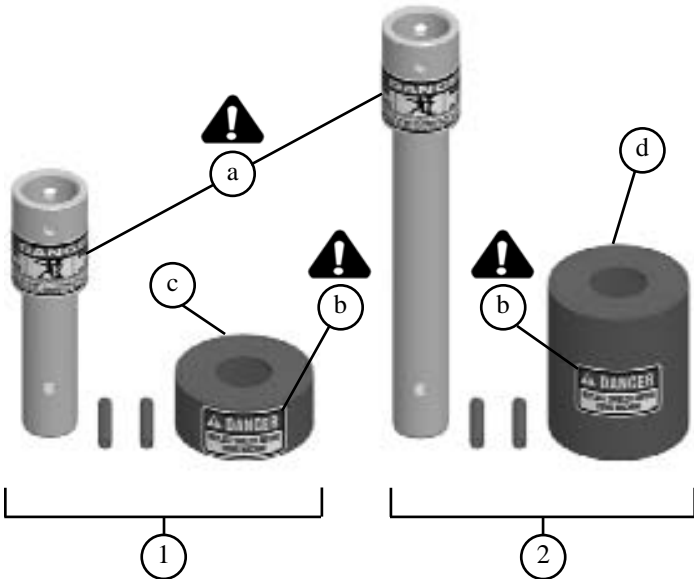

Ref. No.	Description	Part No.
1	7" Auger Extension with 2 Special Coiled Pins & Auger Extension Guard . . .6080G	
2	14" Auger Extension with 2 Special Coiled Pins & Auger Extension Guard . . .6204G	
a	Safety Sign . . . . .PHDC5	
b	Safety Sign . . . . .2169	
c	Decal . . . . .6260	
d	Decal . . . . .6262	

= Safety Sign Location

Auger extensions with Auger Extension Guards are available in lengths of 7 and 14 inches for extra hole depth. Make sure your tractor can accommodate the extra length and still have adequate clearance. Use **only** factory supplied coiled pins to connect the auger to the auger extension. Two coiled pins are shipped with the auger extension, one to install and one spare. When installed, the coiled pin must be flush with the sides of the auger, and the area should be covered by the Auger Extension Guard. The auger retaining bolt should be covered by the Auger Adapter Guard.

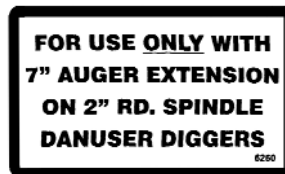

c



d